

Adjusting rocker bars 60 mm

Product description:

The adjusting rocker bar is a metal construction element which is produced by compression molding from rolled metal zinc sheet with thickness of 0.80 mm or 1.00 mm. The hanger is produced with circle and oval openings which are used for anchoring into the building construction and mounting the metal profiles using self-drilling screws. Main difference in comparison with profile bracket is pressed bend which gives the hanger acoustic properties and higher loading.

Range of usage:

The product is used for metal profiles mounting into vertical, horizontal or sloping construction of the buildings. Používají se především v místnostech, kde je předepsaná vyšší požární odolnost či zatížení.

Characteristics:

Material	Rolled sheet DX51
Coating	Zinc – min Z100 (ČSN EN 10327)
Thickness	0.80 mm / 1.00 mm (ČSN EN 10143)
Reaction to fire	Class A1 (EN 14195)
Durability	Class B
Hazardous substance	NPD



Product variability:

Code	Name	Load	Pack	Weight
TMD-0116 (1.348103 T)	Adjusting rocker bar 60/035 – 0.80 mm	0,60 kN	100 pcs	0,0319 kg
TMD-0117 (1.348104 T)	Adjusting rocker bar 60/065 – 0.80 mm	0.60 kN	100 pcs	0,0410 kg
TMD-0118 (1.348105 T)	Adjusting rocker bar 60/095 – 0.80 mm	0.60 kN	100 pcs	0,0502 kg
TMD-3251 (1.348105.120)	Adjusting rocker bar 60/120 – 1.00 mm	0.60 kN	100 pcs	0,0754 kg
TMD-0119 (1.348105.150)	Adjusting rocker bar 60/150 – 1.00 mm	0.60 kN	100 pcs	0,0895 kg
TMD-0974 (1.348105.170)	Adjusting rocker bar 60/170 – 1.00 mm	0.60 kN	25 pcs	0,0957 kg
TMD-3399 (1.348105.200)	Adjusting rocker bar 60/200 – 1.00 mm	0.60 kN	25 pcs	0,1095, kg
TMD-3610 (1.348105.250)	Adjusting rocker bar 60/250 – 1.00 mm	0.60 kN	25 pcs	0,1392 kg
TMD-3432 (1.348105.300)	Adjusting rocker bar 60/300 – 1.00 mm	0.60 kN	25 pcs	0,1632 kg
TMD-3611 (1.348105.350)	Adjusting rocker bar 60/350 – 1.00 mm	0.60 kN	25 pcs	0,1872 kg
TMD-3612 (1.348105.400)	Adjusting rocker bar 60/400 – 1.00 mm	0.60 kN	25 pcs	0,2112 kg



Adjusting rocker bars 60 mm

TMD-3613 (1.348105.450)	Adjusting rocker bar 60/450 – 1.00 mm	0.60 kN	25 pcs	0,2352 kg
TMD-3614 (1.348105.500)	Adjusting rocker bar 60/500 – 1.00 mm	0.60 kN	25 pcs	0,2592 kg
TMD-3886 (1.348104 T15)	Adjusting rocker bar 60/065 - 0.80 mm (blistr 15 ks)	0,60 kN	15 pcs	0,615 kg
TMD-3887 (1.348105 T15)	Adjusting rocker bar 60/095 - 0.80 mm (blistr 15 ks)	0,60 kN	15 pcs	0,960 kg

Real weight may vary in range of +/-5% according to ČSN EN10143



Mounting:

Mount the rocker bar into the solid structure with self-tapping screws or ceiling anchor. Bend the sides of the bracket by 90° so only a middle part would stay anchored. Insert the 60 mm profile between the bended sides and secure it into the position with self-drilling screws.

Packaging:

The brackets up to length of 150 mm are packed by 100 pcs in carton box. Longer variations are packed by 25 pcs with stretch foil. Every dimension is labeled with identification tag.

Blister packing of rocker bars 65 and 95 mm consists of 15 pcs in transparent plastic casing covered by cardboard plate with a description of the product.

Recommended storage:

The product is required to store in dry and temperate environment in order to prevent condensation on the surface of the product and damage to the packaging.

Technical drawing:

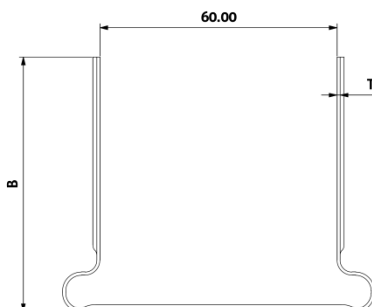
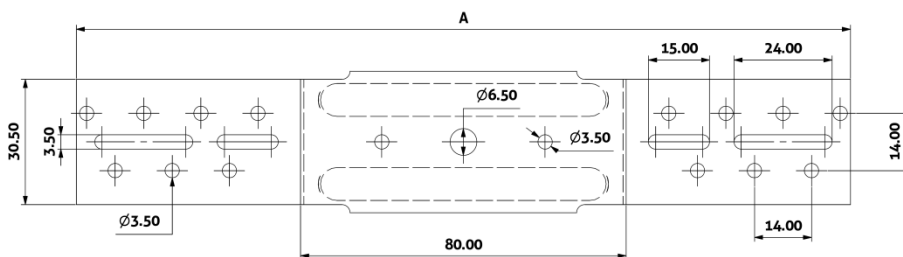

Kód	Produkt	T	A	B	Váha
TMD-0116	Stavěcí třmen 60/035	0.80 mm	130 mm	35 mm	0,0319 kg
TMD-0117	Stavěcí třmen 60/065	0.80 mm	190 mm	65 mm	0,0410 kg
TMD-0118	Stavěcí třmen 60/095	0.80 mm	250 mm	95 mm	0,0502 kg
TMD-3251	Stavěcí třmen 60/120	1.00 mm	300 mm	120 mm	0,0754 kg
TMD-0119	Stavěcí třmen 60/150	1.00 mm	360 mm	150 mm	0,0895 kg
TMD-0974	Stavěcí třmen 60/170	1.00 mm	400 mm	170 mm	0,0957 kg
TMD-3399	Stavěcí třmen 60/200	1.00 mm	460 mm	200 mm	0,1095 kg
TMD-3610	Stavěcí třmen 60/250	1.00 mm	560 mm	250 mm	0,1392 kg
TMD-3432	Stavěcí třmen 60/300	1.00 mm	660 mm	300 mm	0,1632 kg
TMD-3611	Stavěcí třmen 60/350	1.00 mm	760 mm	350 mm	0,1872 kg
TMD-3612	Stavěcí třmen 60/400	1.00 mm	860 mm	400 mm	0,2112 kg
TMD-3613	Stavěcí třmen 60/450	1.00 mm	960 mm	450 mm	0,2352 kg
TMD-3614	Stavěcí třmen 60/500	1.00 mm	1060 mm	500 mm	0,2592 kg

