

Suspension sets H+H

Product description:

The element is consisted of two galvanized steel wires with diameter of 4 mm and the butterfly clip with thickness of 0.60 mm. It is primarily used for anchoring the suspended cassette construction. The hook on the both sides of the set allows quick fixing into the building structure and insertion of the T-profile.

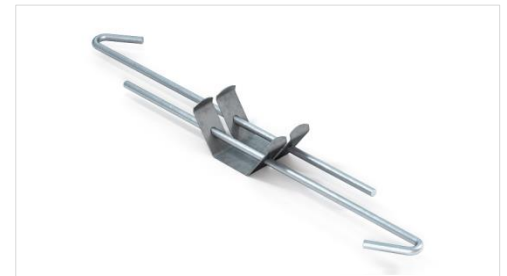

Range of usage:

The product is used for fixing the drywall elements into solid structures of buildings. It is used to reduce the ceiling in plasterboard or cassette structures.

Characteristics:

Material	Drawn wire / spring steel
Coating	Zinc – min Z100 (ČSN EN 10327)
Thickness	4.00 mm / 0.60 mm (ČSN EN 10143)
Reaction to fire	Class A1 (EN 14195)
Durability	Class B
Hazardous substance	NPD

Product variability:

Code	Name	Load	Pack	Weight
TMD-3666	Suspension set H/H - 0090 x 0090 (80-140 mm)	0,40 kN	100 pcs	0,0330 kg
TMD-3667	Suspension set H/H - 0115 x 0115 (100-190 mm)	0,40 kN	100 pcs	0,0380 kg
TMD-3668	Suspension set H/H - 0165 x 0165 (150-290 mm)	0,40 kN	100 pcs	0,0476 kg
TMD-5019	Suspension set H/H - 0215 x 0215 (200-390 mm)	0,40 kN	100 pcs	0,0474 kg
TMD-3927	Suspension set H/H - 0250 x 0250 (235-460 mm)	0,40 kN	100 pcs	0,0642 kg
TMD-3949	Suspension set H/H - 0315 x 0315 (300-590 mm)	0,40 kN	100 pcs	0,0770 kg
TMD-3672	Suspension set H/H - 0315 x 0715 (700-990 mm)	0,40 kN	50 pcs	0,1162 kg
TMD-3673	Suspension set H/H - 0315 x 1015 (1000-1290 mm)	0,40 kN	50 pcs	0,1456 kg
TMD-3928	Suspension set H/H - 0315 x 1215 (1200-1490 mm)	0,40 kN	50 pcs	0,1652 kg
TMD-3951	Suspension set H/H - 0315 x 1515 (1500-1790 mm)	0,40 kN	50 pcs	0,1946 kg
TMD-3952	Suspension set H/H - 0315 x 1715 (1700-1990 mm)	0,40 kN	50 pcs	0,2142 kg
TMD-3671	Suspension set H/H - 0415 x 0415 (400-790 mm)	0,40 kN	50 pcs	0,0966 kg
TMD-3929	Suspension set H/H - 0515 x 0515 (500-990 mm)	0,40 kN	100 pcs	0,1162 kg



Suspension sets H+H

TMD-3389	Suspension set H/H - 0515 x 1015 (1000-1490 mm)	0,40 kN	50 pcs	0,1652 kg
TMD-3329	Suspension set H/H - 0815 x 0815 (800-1590 mm)	0,40 kN	50 pcs	0,175 kg
TMD-3953	Suspension set H/H - 1015 x 1015 (1000-1990 mm)	0,40 kN	50 pcs	0,2142 kg

Real weight may vary in range of +/-5% according to ČSN EN10143



Packaging:

The suspension sets to length of 515 mm are packed by 100 pcs in carton box. Longer variations are packed by 50 pcs with cable tie. Every dimension is labeled with identification tag.

Recommended storage:

The product is required to store in dry and temperate environment in order to prevent condensation on the surface of the product and damage to the packaging.

Technical drawing:

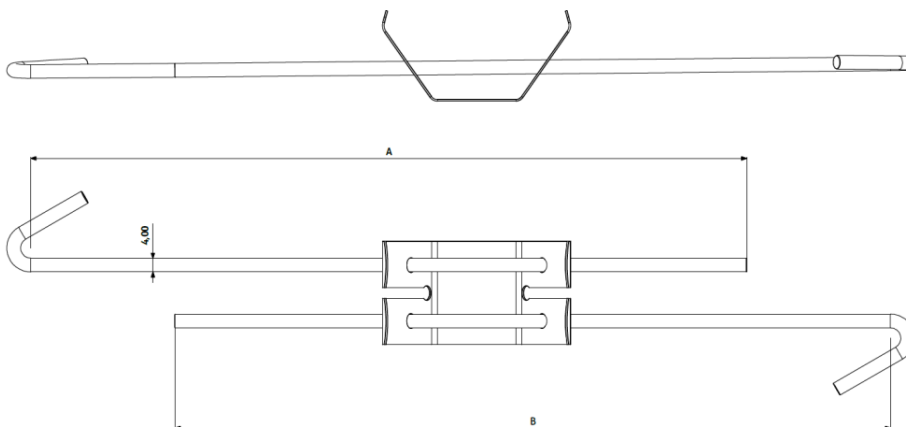

Kód	Produkt	A	B
TMD-3666	Suspension set H/H - 0090 x 0090 (80-140 mm)	90mm	90mm
TMD-3667	Suspension set H/H - 0115 x 0115 (100-190 mm)	100 mm	100 mm
TMD-3668	Suspension set H/H - 0165 x 0165 (150-290 mm)	150 mm	150 mm
TMD-5019	Suspension set H/H - 0215 x 0215 (200-390 mm)	200 mm	200 mm
TMD-3927	Suspension set H/H - 0250 x 0250 (235-460 mm)	250 mm	250 mm
TMD-3949	Suspension set H/H - 0315 x 0315 (300-590 mm)	300 mm	300 mm
TMD-3672	Suspension set H/H - 0315 x 0715 (700-990 mm)	300 mm	700 mm
TMD-3673	Suspension set H/H - 0315 x 1015 (1000-1290 mm)	300 mm	1000 mm
TMD-3928	Suspension set H/H - 0315 x 1215 (1200-1490 mm)	300 mm	1200 mm
TMD-3951	Suspension set H/H - 0315 x 1515 (1500-1790 mm)	300 mm	1500 mm
TMD-3952	Suspension set H/H - 0315 x 1715 (1700-1990 mm)	300 mm	1700 mm
TMD-3671	Suspension set H/H - 0415 x 0415 (400-790 mm)	400 mm	400 mm
TMD-3929	Suspension set H/H - 0515 x 0515 (500-990 mm)	500 mm	500 mm
TMD-3389	Suspension set H/H - 0515 x 1015 (1000-1490 mm)	500 mm	1000 mm
TMD-3329	Suspension set H/H - 0815 x 0815 (800-1590 mm)	800 mm	800 mm
TMD-3953	Suspension set H/H - 1015 x 1015 (1000-1990 mm)	1000 mm	1000 mm

